

# NO.5 MARTIN PLACE

Sydney NSW

---



## Project Exclusive

5 Martin Place is a high-profile redevelopment of Sydney's iconic "Money Box" building. The building comprises over 31,000m<sup>2</sup> of premium grade office space 2,500m<sup>2</sup> of retail space.

In 2015, for the fourth time in its history, 5 Martin Place was re-transformed. This time, out-of-the-box thinking was the key to creating a result that made economic sense, met the challenging planning constraints and remained true to the heritage elements of the site.

The architectural solution was to demolish the 1968 building and construct a new 20 level building. To make use of all available area and maintain project viability, it was proposed to cantilever nearly half of the building from Level 11 to Level 20, 22 meters over the buildings constructed in 1916 and 1933.

This amazing development stayed true to its heritage and remains an iconic landmark in the city of Sydney.

## THE WHO'S WHO

---

### CLIENT

Dexus

CBUS

### ARCHITECT

Johnson Pilton Walker

TKD Architects

### BUILDER

Grocon

# The Access Floor Scoop

This commercial tower encompasses over 18,800m<sup>2</sup> of ASP's commercial ICON X System. The comms rooms within the tower utilise ASP's ICON DATA HPL.

5 Martin Place provided a challenging and rewarding project for ASP Access Floors with its large central atrium and its fusion between the existing heritage building and the new built tower wing.

The design of the large central atrium presented ASP's engineers an opportunity to utilise our cantilevered access floor detail, in order to achieve Johnson Pilton Walker's design.

ASP engineered a solution to the large expansion joint between the heritage building and new tower, so that the access floor was able to run seamlessly through this transition point.

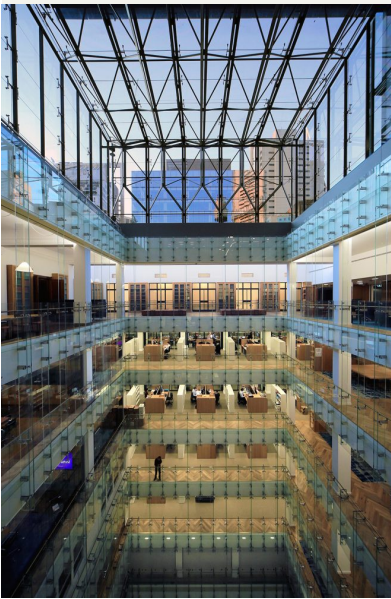

# Sustainability Trends



AUSTRALASIA **EPD**<sup>®</sup>  
ENVIRONMENTAL PRODUCT DECLARATION

 greenstar

 NABERS

# Did You Know

10 Storeys Cantilevered

18,800m<sup>2</sup> of Access Floor

4th Historic Redevelopment

# Featured Products

## ICON X

ICON X is considered the classic system for commercial environments. Featuring the patented ASP Icon Panel with a steel cementitious construction.

## ICON DATA HPL

ICON Data HPL is a finished system providing static-dissipative access floor panels.